

Marguerite Gahagan Nature Preserve

off M18 and Southline Rd. directly behind Compost Center - Roscommon

Peaceful hiking trails amongst mature white and red pine forest and cedar swamp. This is an area working to protect habitat and wildlife forever. The Preserve is open to the public from dawn until dusk. One trail is paved and wheelchair accessible.

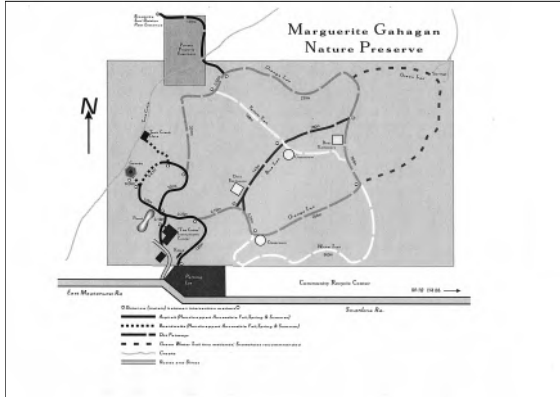

Hartwick Pines State Park

4216 Ranger Road - Grayling
(989)348-7068

With an area of 9,672 acres, Hartwick Pines is the largest State Park in the Lower Peninsula. The park's rolling hills are built of ancient glacial deposit and overlook the valley of the East Branch of the AuSable River. It also has four small lakes and unique timberlands. The principal feature of this park is the 49-acre forest of Old Growth Pines, which gives the park its name. There is also a logging museum ¼ mile away from the Visitor Center which brings the logging industry into new light from one of Michigan's largest remaining stands of virgin white pine.

Red Pine Natural Area

Eight miles north of St. Helen via F-97 & Sunset Road
It has 1.5 miles that can be hiked, biked and

North Higgins Lake State Park Trails

Consists of 3 loops through scenic wooded areas. The hiking trails are located across the road from the camping and beach areas behind the Civilian Conservation Corps Museum area.

An Upland Nature Trail is a 1.5 mile trail. It also contains 27 fitness stations which describe a defined set of fitness activities that can be done along the trail.

Bosom Pines Trail is a 3.8 mile trail that winds through gently rising uplands areas of pine and hardwoods.

The Beaver Creek Trail is 6.5 miles of trail similar to the Bosom Pines Trail, offering a range of scenery.

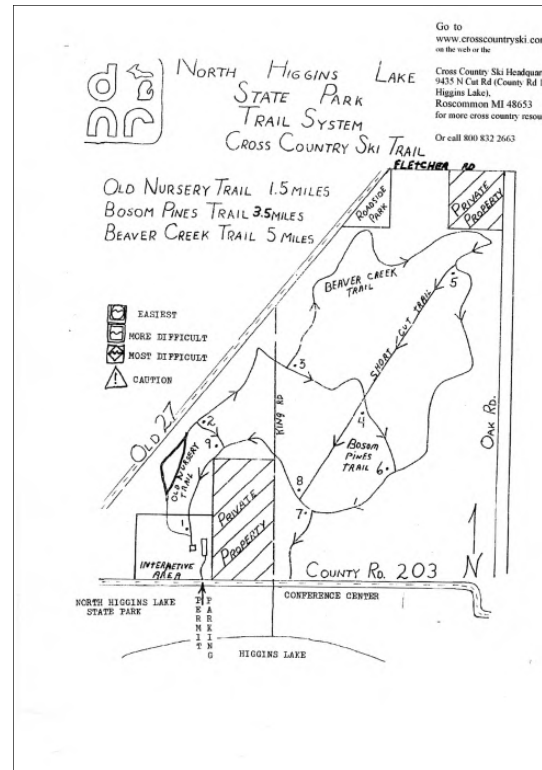

HOUGHTON LAKE AREA TOURISM BUREAU

Michigan's Other Great Lakes

TAKE A HIKE! TRAILS AND PATHWAYS TO WALK OR BIKE



**HOUGHTON LAKE
HIGGINS LAKE
LAKE ST. HELEN**

www.visithoughtonlake.com

989.366.8474

Lost Twin Lakes Trail

This trail is located 7 miles south of Houghton Lake on Reserve Rd (County Road 400). This 3 mile loop trail winds through an old growth pine forest. Designed for hiking and cross-country skiing this trail has several bridges, including a covered bridge. The trail contains scenic overviews of pristine wetlands.

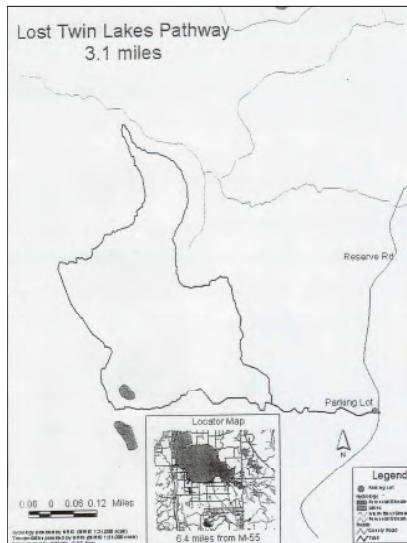

Skinner Park

On Knapp Rd. in Houghton Lake (at Roscommon Twp hall)
New half mile trail through the pine trees - also nice for snowshoeing and cross country skiing.

Lansing Road

4 miles of Lansing Road between M18 and Flint Road - Dedicated as a Natural Beauty Road. It contains a large tract of natural white birch (which is believed to be the largest in Michigan). This large tract of land is traversed by the quietly flowing Cut River. A small bridge on Lansing Road allows fishing along the Cut River

Marl Lake

In the area around Marl Lake there are three loop trails: Green Trail - 2 miles of trail, Red Trail - 3.5 mile loop much of it on the edge of the lake, Blue Trail - 5.5 mile loop with ½ of it along the edge of the lake.

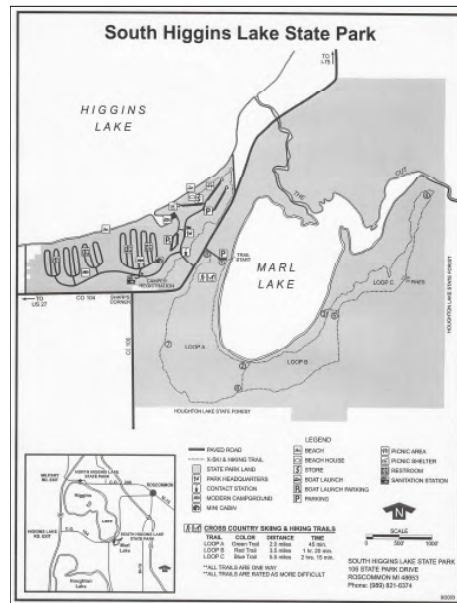

Tisdale Triangle

½ mile from Roscommon via M-18 and Tisdale Road.
Woodland areas of natural-groomed trails, the Tisdale Triangle is This stretch of trail is 8.5 miles and designed for mountain biking, hiking and cross-country skiing.

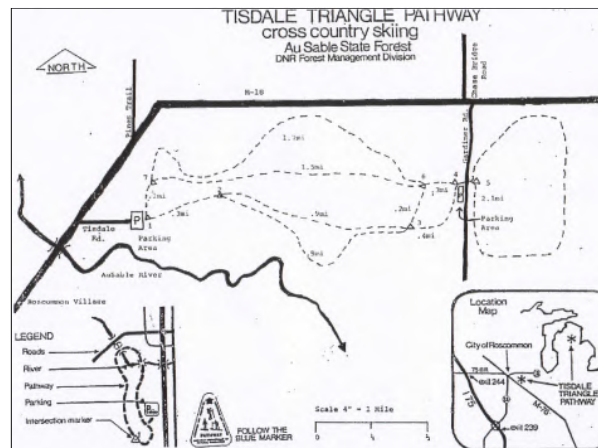

Mason Tract

South entrance - about 5 miles north of Roscommon on Chase Bridge Rd. just off of M-18 (989) 348-6371
The trail is about 11.5 miles long, created for hiking and biking. The Mason tract contains the ruins of the Durant Castle; it also contains a beautiful wilderness chapel.

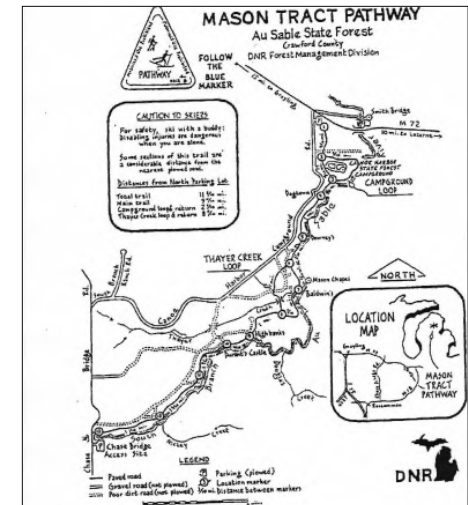

Cross Country Ski Headquarters

9435 N Cut Rd (Cty Rd 100) Roscommon, MI 48653
(800) 832-2663

This charming Nordic Skiing / Snowshoeing center includes 18 km of trails for hiking and non-motorized bicycles in the off-ski season.

