

BT SERIES FOR VALVES UP TO 21,000 INCH POUNDS OF TORQUE

BT SERIES FEATURES

- FOR 3" THROUGH 12" VALVE SIZES DEPENDING ON VALVE TORQUE, MEDIA AND LINE PRESSURE
- PROVIDES AUTOMATIC CLOSURE IN THE EVENT OF FIRE
- VALVE CAN BE OPERATED MANUALLY WITH GEAR AFTER DISARMING
- SOLDERED FUSIBLE LINKS AVAILABLE TO 440° F
- API 607 FIRE SAFE VALVE AVAILABLE WITH ANSI 150# FLANGED, SOCKET WELD OR NPT ENDS



The BT fusible link assembly incorporates a declutchable gear operator to normally operate the valve after disarming.

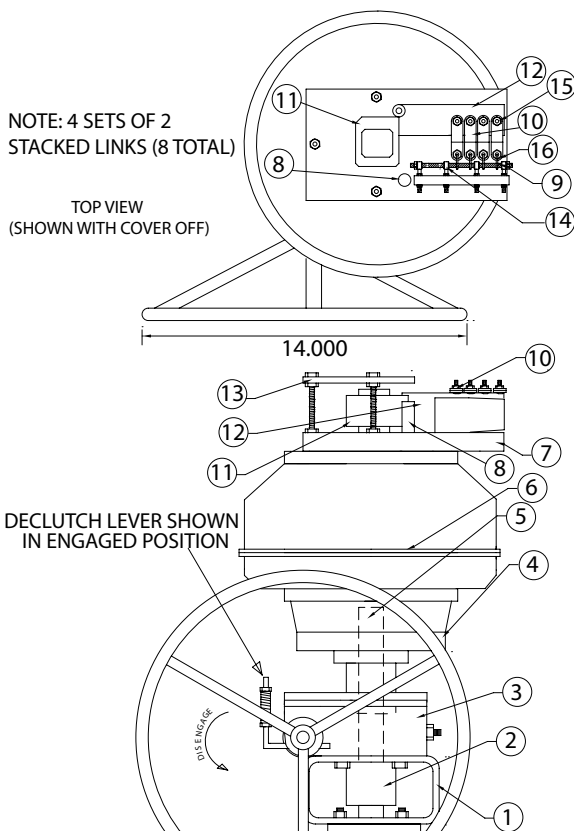

1	valve mounting bracket	9	fusible link retaining rod
2	valve coupler	10	fusible links (8)
3	declutchable override gear	11	spring pack stop assembly
4	spring pack mounting plate	12	locking trigger
5	spring pack/declutch coupler	13	safety cover plate
6	spring pack (14X, 14, 16, 18)	14	rod end bearings
7	arming device mounting plate	15	shoulder bolts
8	safety stop pin	16	SupaLoops

HEAVY DUTY SPRING PACK

The armed spring pack features weatherproof sealed spring housing and corrosion resistant epoxy paint. The reliable low stress clock springs assure quick closing action when the fusible links yield.

CUSTOMIZED MOUNTING HARDWARE

A heavy-duty gauge bracket and top plate provide the durable, secure construction that AVK Carbo-Bond products are known for. An all stainless bracket, coupling, arming plate and hardware kit also are available.

FACTORY ASSEMBLED

All AVK Carbo-Bond fusible link assemblies are assembled by factory-trained personnel. The units then are armed with a protective safety link for shipping purposes.

DECLUTCHABLE MANUAL OVERRIDE

The BT-series features a declutchable gear operator to arm the assembly or to operate the valve once the links are disengaged.

RELIABLE FUSIBLE LINKS

AVK Carbo-Bond fusible links are designed to remain secure until releasing the spring pack when the desired temperature is reached. Soldered type fusible links are available in these temperature ranges:

LINK PART NUMBER	LINK YIELD TEMPERATURE	MAX. AMBIENT TEMP.
WS2-72	162° F / 72° C	109° F / 42° C
WS2-93	200° F / 93° C	145° F / 63° C
WS2-141	286° F / 141° C	232° F / 111° C
WS2-182	360° F / 182° C	305° F / 152° C
WS2-227	440° F / 227° C	386° F / 197° C

NOTE: BT-series only FM-approved with FL-1 link styles; consult factory for FM-approved options. 14X spring pack uses K links.