

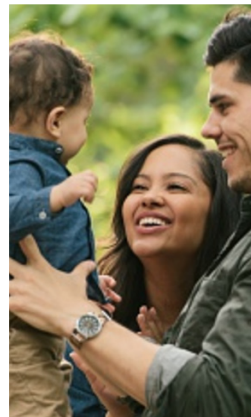

# Help Me Grow<sup>®</sup>

## NATIONAL FORUM AGENDA

Greenville, SC | May 23-25, 2016



## Advancing Developmental Promotion, Early Detection & Linkage to Services



“ We have learned many lessons through the replication of *HMG* across the country. Chief among them is this:

***When states, leaders, and communities share a strong commitment to the strength of families, then they are more likely to devote resources to supporting early childhood system-building and early detection of vulnerable children.***

A keystone of our work—and what supports the widespread appeal of *Help Me Grow*—is a broad commitment to family engagement.

Families, not state-operated programs and services, are the most crucial influence on children’s healthy development.

We must continue to seek guidance from across the political spectrum, as all sides offer valuable insights into how to best support and strengthen families with all the tools we have, from programs to services to systems to policies.”

Paul Dworkin, Founding Director,  
*Help Me Grow* National Center  
April 2015

# TABLE OF CONTENTS

**MONDAY, MAY 23** **PAGE 4**

**TUESDAY, MAY 24** **PAGE 6**

**WEDNESDAY, MAY 25** **PAGE 10**

*Breakout Sessions 1* *page 12*

*Breakout Sessions 2* *page 15*

*Breakout Sessions 3* *page 18*

**VENUE MAP** **PAGE 20**

**FORUM COMMITTEE &  
HMG NATIONAL STAFF** **PAGE 23**

**FORUM SPONSORS** **PAGE 24**

# **MONDAY MAY 23**

## **10 a.m.-12 p.m. & 2-4:30 p.m. Forum Registration Opens**

*LOCATION: Outside Regency Ballroom*

## **12:30-2:30 p.m. OPTIONAL SITE VISITS**

*All Site Visit participants should meet in the hotel lobby no later than 12:15 p.m.*

### **South Carolina Care Coordination Central**

Our care coordination team will share SC's unique approach to assisting families. You will also participate in a case review and see the call center environment.

*LOCATION: Children's Advocacy, Greenville Health System-Patewood Campus.  
Transportation will be provided from the Hyatt Regency Greenville.*

### **Physician Outreach 101**

*Help Me Grow SC* has made physician outreach a strategic priority. About 33% of families served by *HMG SC* connect to us through their child's physician. Hear about our successful physician outreach effort and speak with some of our physician champions.

*LOCATION: The Children's Museum of the Upstate. This visit requires a four-block walk to the museum.*

### **Public Policy and Advocacy for Children**

By recognizing the importance of early childhood development and investing in children, we can all help to initiate critical change to create high-quality early childhood systems. Launched in 2010, the Institute for Child Success (ICS) is a Greenville-based, private, nonpartisan research and policy organization working to create a culture that facilitates and fosters the success of all children. Come learn about the Institute's advocacy work and share ideas from your state.

*LOCATION: The United Way of Greenville County. Transportation will be provided from the Hyatt Regency Greenville.*



# **MONDAY MAY 23**

## **3-4:30 p.m. REGIONAL NETWORKING**

### **LOCATIONS:**

*Central Region - Regency F*

*Northeast Region - Regency H*

*Southeast Region - RedBud A/B*

*Western Region - Regency Ballroom*

## **5:30-7 p.m. OPENING SESSION & RECEPTION**

### **LOCATION:**

*Genevieve's Peace Center for the Performing Arts Complex*

*300 S Main Street, Greenville, SC 29601*

*The venue is a 10- to 15-minute walk from the Hyatt Regency Greenville.*

*Walking directions are included in your registration folder. Please see registration staff if you have any questions.*

### **5:30 p.m. Appetizers & Networking**

### **6 p.m. Welcome to South Carolina**

### **7 p.m. Dinner on Your Own!**

*There is no formal dinner on Monday. Participants are free to make dinner plans as they wish.*

## **TUESDAY MAY 24**

### **7:30-8:30 a.m. Forum Registration**

*LOCATION: Outside Regency Ballroom*

### **7:45 a.m. Networking at Breakfast**

*LOCATION: Regency A/B*

## **8:30 a.m. WELCOME TO THE 7TH ANNUAL HMG FORUM**

**Joanna Bogin**, Senior Consultant, *HMG* National Center

**Paul Dworkin** Founding Director, *HMG* National Center

*LOCATION: Regency Ballroom*

## **8:45 a.m. CELEBRATING SUCCESSES IN SOUTH CAROLINA**

**Desmond Kelly** *HMG* Medical Director, *HMG* SC

**Jane Witowski** *HMG* Manager, *HMG* SC

*LOCATION: Regency Ballroom*

## **9:15 a.m. HMG NATIONAL UPDATE**

**Kimberly Martini-Carvell** Executive Director, *HMG* National Center

*LOCATION: Regency Ballroom*

## **10-10:15 a.m. BREAK**



# TUESDAY MAY 24

## 10:15-11:45 a.m. BREAKOUT SESSIONS 1

- |     |  |
|-----|--|
| 1.1 | <i>Similar Goals on Different Coasts: Universal Developmental Screening and Connection to Services</i>   |
| 1.2 | <i>Building Capacity for Electronic Screening &amp; Electronic Exchange of Results</i>   |
| 1.3 | <i>Training Tools for Early Care and Healthcare Professionals</i>  |
| 1.4 | <i>HMG Western New York's Impact on At-Risk Pre-Kindergarten Students</i>  |
| 1.5 | <i>Dancing with Data II: Predictors of Environmental Stress and Risk for Social Emotional and Developmental Delay (Implications for Care Coordination)</i> |
| 1.6 | <i>Bring on the Baby Bump</i>  |
| 1.7 | <i>Collaborating with CDC's "Learn the Signs. Act Early." to Increase Parent-Engaged Developmental Monitoring</i>  |

**Turn to page 12 for session descriptions**

## 11:45 a.m. LUNCH

*LOCATION: Regency A/B*

## TUESDAY MAY 24

### 12:30 p.m. TRANSFORMATIVE FUNDING: A DISCUSSION WITH THOUGHT LEADERS

*moderated by Paul Dworkin, Founding Director, HMG National Center*

**Richard Sussman** Director, Early Childhood Investments, Hartford Foundation for Public Giving

**Joe Waters** Executive Vice President, Institute for Child Success

**Tana Ebbale** Advisor to the Poverty Program, The JPB Foundation

*LOCATION: Regency Ballroom*

### 1:30-3 p.m. BREAKOUT SESSIONS 2

- |     |   |
|-----|---|
| 2.1 | <i>A Help Me Grow Dinner Party: Bringing Collaborators to the Table</i>   |
| 2.2 | <i>Creating a Message that Matters</i>  |
| 2.3 | <i>The Pediatric Resident Help Me Grow Experience: Engaging Health Professionals</i>  |
| 2.4 | <i>Building a Successful Resource Inventory: Going Beyond Updates &amp; Additions</i>   |
| 2.5 | <i>Nothing about Families without Families: Effective Strategies for Diverse Family Leadership and Engagement</i>                     |
| 2.6 | <i>Integrating HMG with CenteringPregnancy® and CenteringParenting®</i>   |
| 2.7 | <i>Advancing Developmental Promotion, Early Detection &amp; Linkage to Services through Mid-level Developmental Assessment (MLDA)</i> |
| 2.8 | <i>Data, Data Everywhere! Where Can It Lead?</i>  |

**Turn to page 15 for session descriptions**



## TUESDAY MAY 24

**3-3:15 p.m.** BREAK

**3:15 p.m.** *HMG SYSTEM MODEL: AN EVALUATION FRAMEWORK*

Erin Cornell Program Manager for Research, Innovation & Evaluation, *HMG* National Center

Von Jessee Program Specialist for Research and Evaluation, *HMG* National Center

Sarah Zucker Program Specialist for Innovation, Collaboration & Production, *HMG* National Center

*LOCATION: Regency Ballroom*

### ***PARTICIPANT CHOICE***

**4:30-5:30 p.m.** *HMG SYSTEM MODEL FIDELITY*

*LOCATION: Regency Ballroom*

*OR*

**4:30-5:30 p.m.** NETWORKING ACTIVITY

Ericka Dickerson ECCS/*HMG* Coordinator, *HMG* NJ

Catherine Miller Project Manager, *HMG* MO

*LOCATION: Crepe Myrtle Room*

**5:30-6:30 p.m.** RECEPTION FOR JOANNA BOGIN

*LOCATION: Regency A/B*

*Cash Bar & Light Appetizers*

# WEDNESDAY MAY 25

7 a.m. **Registration for Breakfast Networking Sessions**

*LOCATION: Outside Regency Ballroom*

7:45 a.m. **Breakfast Networking Sessions**

**8:30-9:30 a.m. KEYNOTE** NETWORKS OF OPPORTUNITY FOR CHILD WELLBEING: INNOVATIVE STRATEGIES TO ALIGN AND INTEGRATE EARLY CHILDHOOD SYSTEMS

**Renée Boynton Jarrett MD, ScD**, Boston University School of Medicine  
Founding Director, Vital Village Community Engagement Network

*LOCATION: Regency Ballroom*

**9:30-11 a.m. BREAKOUT SESSIONS 3**

- 3.1** *Utilizing the “Learn the Signs. Act Early.” Campaign Materials to Increase Early Identification in WIC Offices in Alameda County*
- 3.2** *Successes & Challenges in Serving Children in Foster Care: Lessons Learned from a Two-Year South Carolina Pilot Project*
- 3.3** *Partnerships = Growth = Sustainability*
- 3.4** *Help Me Grow and Early Childhood Integrated Data Systems*
- 3.5** *Reach out and Read & Help Me Grow: A Win! Win!*
- 3.6** *Igniting Parent Power in Developmental Promotion, Screening & Linkages*

**Turn to page 18 for session descriptions**

## **WEDNESDAY MAY 25**

**11-11:15 a.m. BREAK**

**11:15 a.m.-12:45 p.m. DIFFUSION OF INNOVATION**

*panel moderated by Scott Orsey, Director, Operations & Strategy, Office for Community Child Health, Connecticut Children's Medical Center*

**HMG South Carolina – Care Coordination Collaborative**

**Loretta Crowley** Community Outreach Coordinator, HMG SC

**Brooke T. Culclasure** Research Director, Center for Education Policy and Leadership, Riley Institute at Furman University

**HMG Vermont – Mid-level Developmental Assessment**

**Janet Kilburn** HMG VT, VT Department of Public Health

**Susan Vater** Consultant, Village for Families and Children

**Susan Roman** Program Director, Center for Care Coordination, CT Children's Medical Center

*LOCATION: Regency Ballroom*

**12:45-2 p.m. STATE MEETINGS (LUNCH SERVED)**

**2 p.m. AFFILIATE VISIONS FOR THE FUTURE**

*facilitated by Kimberly Martini-Carvell, Executive Director, HMG National Center*

*LOCATION: Regency Ballroom*

**3-3:30 p.m. CLOSING REMARKS**

**Paul Dworkin** Founding Director, HMG National Center

*LOCATION: Regency Ballroom*

# TUESDAY MAY 24 BREAKOUT SESSIONS 1

10:15 - 11:45 a.m.

1:1

## Similar Goals on Different Coasts: Universal Developmental Screening and Connection to Services

Learn how *HMG* Affiliates from Orange County, California and South Carolina seek to improve communication and collaboration among community and health care providers by conducting developmental screening to ensure children are identified and connected to services. Highlights of similar implementation efforts from Developmental Screening Networks will be shared. **Location: Redbud A/B**

*PRESENTERS*

**Rebecca Hernandez** Program Manager, *HMG* Orange County, CA  
**Jane Witowski** Program Manager, *HMG* SC  
**Lorraine Cragan-Sullivan** Developmental Screening Coordinator, *HMG* SC

1:2

## Building Capacity for Electronic Screening & Electronic Exchange of Results

Oregon and Minnesota will provide information on each state’s work building a system for electronic screening and health information exchange. Each state will share successes, challenges, and practical lessons learned. Ample time will be included for discussion and sharing from participants. **Location: Crepe Myrtle**

*PRESENTERS*

**Sherri Alderman** State Lead, *HMG* OR, OR Health Authority  
**Shawn Holmes** *HMG* Planning Team, MN Dept of Health Reps., MN ECCS Coordinator  
**Katy Schalla Lesiak** *HMG* Planning Team, MN Dept of Health Reps., MN ECCS Coordinator

1:3

## Training Tools for Early Care and Healthcare Professionals

This session will feature the training curriculum developed for Florida by *HMG* National. The presenters will share a wealth of resources that can be used to provide trainings to early care and healthcare professionals including: Scripted PowerPoints, pre/post-tests and training evaluations, supplemental resource materials, recorded training modules, and elevator speeches. **Location: Gardenia**

*PRESENTERS*

**Katherine Suarez Espinosa** State Coordinator, *HMG* FL  
**Liliana Gomez Murphy** State Program and Research Manager, *HMG* FL

## ***TUESDAY MAY 24* BREAKOUT SESSIONS 1**

10:15 - 11:45 a.m.

---

1:4

### ***HMG Western New York's Impact on At-Risk Pre-Kindergarten Students***

Learn how *HMG* WNY works to prevent pre-K children from unnecessary referral to Special Education in high-poverty school districts through screening, teacher training, parent engagement, and links to community services. Discussion to include challenges, lessons learned, and how ASQ can shape classroom strategies. ***Location: Magnolia***

#### ***PRESENTERS***

**Lynn Pullano** Leadership Team Member, Child Care Resource Network

**Jodi Schwegler** *HMG* Coordinator, Child Care Resource Network

1:5

### ***Dancing with Data II: Predictors of Environmental Stress and Risk for Social/Emotional and Developmental Delay (Implications for Care Coordination)***

Together, we will examine developmental screening data, explore environmental stress and potential risk for delay, and share population-level data from the *HMG* Michigan Project. The workshop will cover the collection and analysis of more than 93,000 ASQ screenings and 12,000 social-emotional screenings to highlight findings using population-level data, care coordination results and data driven supports. ***Location: Regency F***

#### ***PRESENTERS***

**Maria Beam** Principal Investigator, Oakland University

**Donna Lackie** Project Director, *HMG* MI

**Connie Sidor** Regional Coordinator, Southeastern MI, Great Start Collaborative

1:6

### ***Bring on the Baby Bump***

Pregnancy is a natural fit in *HMG* services and not as hard to implement as you might think. Join us to see the processes *HMG* Utah underwent to include these expectant parents in services, from connecting to the community to gaining support. The bumps are along the way, but delivery quickly comes. You'll find yourself excited at the prospect of including this expansion in your program. ***Location: Dogwood***

#### ***PRESENTERS***

**Julie Miller** Program Manager, *HMG* UT

**Hillary Michael** Call Center Manager, *HMG* UT

**Kali Iverson** Lead Community Liaison, *HMG* UT



# TUESDAY MAY 24 BREAKOUT SESSIONS 1

10:15 – 11:45 a.m.

**Collaborating with CDC’s “Learn the Signs. Act Early.”  
to Increase Parent-Engaged Developmental Monitoring  
(A Perfect Complement to Developmental Screening!)**

Join us for a lively session to learn about opportunities to team up with CDC’s “Learn the Signs. Act Early.” program. This program works with *Help Me Grow* and other federal and state initiatives and provides free, research-based tools to help parents and providers track developmental milestones, and other resources to empower parents and providers to act early on developmental concerns. The resources provided by CDC are a perfect complement to *Help Me Grow* outreach and education activities and have been integrated into *Help Me Grow* in many states. **Location: Regency H**

*PRESENTERS*

**Katie Green**

Health Communication Specialist, CDC

**Tish MacInnis**

Act Early Ambassador to AL  
Coordinator of Family and Community Partnerships, AL Partnership for Children

**Katie Naman**

*Help Me Grow* AL Director, AL Partnership for Children

**Deepa Srinivasavaradan**

Act Early Ambassador to NJ, Statewide Parent Advocacy Network

**Ericka Dickerson**

ECCS/*Help Me Grow* Coordinator, HMG NJ  
NJ Department of Children and Families  
Family & Community Partnerships, Office of Early Childhood Services

**Janet Kilburn**

Child Development Coordinator & Act Early Ambassador  
HMG VT, VT Department of Health

**Rebecca Webb**

Project Director, VT Child Health Improvement Program, University of VT

1:7

## **TUESDAY MAY 24 BREAKOUT SESSIONS 2**

1:30 – 3 p.m.

---

2:1

### **A *Help Me Grow* Dinner Party: Bringing Collaborators to the Table**

Representatives from three counties in California will share experiences and lessons learned running coalitions designed to improve local care coordination systems for children with special health care needs and how these coalitions complement the *Help Me Grow* system in their county. This session will be facilitated by the Research Program Manager for the Lucile Packard Foundation for Children's Health, which funds the care coordination collaborative portion of the work. **Location: Dogwood**

#### **PRESENTERS**

**Holly Henry** Funder, Lucile Packard Foundation for Children's Health, Palo Alto, CA

**Rebecca Hernandez** Program Manager, *HMG* Orange County, CA

**Kelly Mraz** Leadership Team Facilitator, *HMG* San Joaquin County, CA

**Wanda Davis** Program Manager, *HMG* Contra Costa, CA

2:2

### **Creating a Message that Matters**

When promoting your *Help Me Grow* system, your "message" is a top consideration. Join us to learn more about recent marketing research conducted with Utah parents and how we used their feedback to create a new message and marketing campaign to engage our most prized audience: the parents. You will gain hands-on experience in creating a message and have a chance to develop and refine the message you're sending about your *Help Me Grow*. **Location: Regency Ballroom**

#### **PRESENTERS**

**Julie Miller** Program Manager, *HMG* UT

**Kali Iverson** Lead Community Liaison, *HMG* UT

2:3

### **The Pediatric Resident *HMG* Experience: Engaging Health Professionals**

We will demonstrate a *HMG* SC training module that educates pediatric residents on the importance of early identification of developmental and behavioral concerns through surveillance and screening, as well as the role of *HMG* in care coordination. Participants will explore applications for their own programs. **Location: Crepe Myrtle**

#### **PRESENTERS**

**Jill Kelly** Community Outreach Coordinator, *HMG* SC

**Chris Corry** Care Coordinator, *HMG* SC

**Lorraine Cragan-Sullivan** Developmental Coordinator, *HMG* SC

## **TUESDAY MAY 24 BREAKOUT SESSIONS 2**

1:30 – 3 p.m.

---

2:4

### **Building a Successful Resource Inventory: Going Beyond Updates & Additions**

Maintaining an efficient, accurate resource inventory requires constant collaboration and communication among different group members. The session will explore the building and maintenance of a resource inventory system. Participants will also discuss effective strategies for engaging new providers. **Location: Magnolia**

#### **PRESENTERS**

**Deanna Parga** HMG Child Development Community Liaison, HMG Orange County, CA

**Yvette Nunez** HMG Child Development Community Liaison, HMG Orange County, CA

**Amy Arambulo** 2-1-1 Operations Manager, 2-1-1 Orange County, CA

2:5

### **Nothing about Families without Families:**

#### **Effective Strategies for Diverse Family Leadership and Engagement**

Family Voices and HMG partners from Vermont and New Jersey will lead a lively discussion on family leadership and engagement. Presenters will share successes in and strategies for engaging diverse family members in participation and leadership roles, and examine how this activity supports the engagement of all families. **Location: Regency H**

#### **PRESENTERS**

**Lisa Maynes** Family Support Director, Health, VT Family Network

**Mercedes Rosa** F2F Director & Culturally Competent Outreach Coordinator, Statewide Parent Advocacy Network, NJ

**Jeannette Mejias** Bilingual F2F Coordinator & Family Resource Specialist, Statewide Parent Advocacy Network, NJ

2:6

### **Integrating HMG with CenteringPregnancy® and CenteringParenting®**

The Greenville Health System Obstetric Center has used the CenteringPregnancy® group prenatal care model since 2007. This session explores the CenteringPregnancy® and CenteringParenting® models and their alignment with core components of *Help Me Grow*. **Location: Redbud A/B**

#### **PRESENTERS**

**John Craine** Regional Director, Boston, MA, Centering Healthcare Institute, Inc.

**Amy H. Picklesimer** Maternal-Fetal Medicine, Dept of Obstetrics and Gynecology, Greenville Health System, Greenville, SC

**Sarah Covington-Kolb** Greenville Health System, Greenville, SC

## **TUESDAY MAY 24 BREAKOUT SESSIONS 2**

1:30 – 3 p.m.

2:7

### **Advancing Developmental Promotion, Early Detection & Linkage to Services through Mid-level Developmental Assessment (MLDA)**

Learn how MLDA can support early and comprehensive assessments in your state. This interactive session gives a brief overview of the MLDA model, what it is, why it's needed, and how it is being implemented in Florida, Vermont and Washington. Highlights will be shared along with information about the technical assistance provided for MLDA diffusion and implementation. **Location: Regency F**

#### **PRESENTERS**

**Susan Vater** MLDA Consultant, Village for Families and Children, CT

**Melissa Argumosa** Program Manager IEDS, FL

**Faith Grant**, HMG Program Manager FL

**Janet Kilburn** Child Development Coordinator & Act Early Ambassador, Dept of Health, VT

**Monica Burke** Program Director, Parent Coalition and Taking Action. The Arc of Whatcom County, WA

2:8

### **Data, Data Everywhere! Where Can It Lead?**

Beyond Common Indicators, what other data can I collect and what can I do with it? Learn how Utah's data-driven culture uses evaluation recommendations for quality improvement and other research to answer their questions. Utah recently asked, "Does *HMG* Utah help develop protective factors?" Innovative research methods yielded great insights into natural family maturation and most importantly, the positive impact of *HMG* on the development of family protective factors. These groundbreaking findings bolster the argument that *HMG* is a valuable system in our communities. **Location: Gardenia**

#### **PRESENTERS**

**Barbara Leavitt** Executive Director, *HMG* UT

**Brian Hill** Evaluator, Greater Ventures, UT

**Karen Hill** Evaluator, Greater Ventures, UT

Speaker bios available at [www.HelpMeGrowNational.org](http://www.HelpMeGrowNational.org)

## WEDNESDAY MAY 25 BREAKOUT SESSIONS 3

9:30 – 11 a.m.

3:1

### Utilizing the “Learn the Signs. Act Early.” Campaign Materials to Increase Early Identification in WIC Offices in Alameda County, California

Discover a successful partnership between *HMG* Alameda County and WIC to promote early identification and linkage to services. Using the CDC’s LSAE materials, such as checklists, developmental graphics and training, this project has increased the number of children participating in WIC who use the *HMG* system. **Location: Magnolia**

#### PRESENTERS:

**Angelina Ahedo** Prevention Manager, *HMG* Alameda County, CA

**Deborah Turner** *HMG* Administrator, First 5 Alameda County, CA

3:2

### Successes & Challenges in Serving Children in Foster Care: Lessons Learned from a Two-Year South Carolina Pilot Project

A unique collaboration between child health care, child welfare, and *Help Me Grow* SC is working to improve outcomes and connection to services for children entering foster care. Hear about their successes and challenges during their two-year pilot effort. Share ideas from your affiliate on ways to work with this population. **Location: Regency F**

#### PRESENTERS

**Lisa Soenen** Program Coordinator-Care Coordination, *HMG* SC

**Nancy Henderson** Medical Director-Forensic Pediatrics, Greenville Health System, SC

**Patti Ertzberger** Program Coordinator, BabyNet (Part C), Greenville District, SC

**Lori Burton** Program Coordinator, Greenville County Department of Social Services, SC

3:3

### Partnerships = Growth = Sustainability

This session will lead participants through Alabama’s five-year journey from planning stages to statewide expansion, highlighting the power of partnerships. The path to success has included establishing and maintaining key partnerships to plan and adapt the *HMG* system for Alabama; implementing the *HMG* model and tracking lessons in a pilot area; and building capacity for statewide coordination within new opportunities. The path has culminated in all Alabama families having access to *HMG* services.

**Location: Gardenia**

#### PRESENTERS

**Gail Piggott** Executive Director, AL Partnership for Children

**Katie Naman** *HMG* AL Director, AL Partnership for Children



## **WEDNESDAY MAY 25 BREAKOUT SESSIONS 3**

9:30 – 11 a.m.

3:4

### ***Help Me Grow* and Early Childhood Integrated Data Systems**

What are the long-term effects of *Help Me Grow*? How can *Help Me Grow* quantify the ripple effects of prevention services? Early Childhood Integrated Data Systems (ECIDS) provide answers to questions that single program data systems cannot answer alone. Through the collection and linking of data across multiple agencies within a state, ECIDS provides a holistic picture of comprehensive programs and services that contribute to positive outcomes for children and families. This session will provide an overview of ECIDS and how *Help Me Grow* will be able to better answer essential questions through contributing and receiving ECIDS data. **Location: Regency H**

**PRESENTERS**

**Colleen Murphy** AEM Corporation

3:5

### **Reach Out and Read & *Help Me Grow*: A Win! Win!**

Reach Out and Read Carolinas and partner providers will discuss the collaboration between ROR and *HMG* in South Carolina. Panelists will discuss the strategic work done together to support a systems level approach to support children and families in the medical home. **Location: Crepe Myrtle**

**PRESENTERS**

**Callee Boulware** Executive Director, Reach Out and Read Carolinas

**Loretta Crowley** Community Outreach Coordinator, *HMG* SC

3:6

### **Igniting Parent Power in Developmental Promotion, Screening & Linkages**

Learn about current strategies and practices to engage, educate and empower parents in their child's development, learning and behavior. This interactive workshop will explore tools for encouraging developmental promotion, creating partnerships with families, and ensuring successful linkages to services. We will also discuss our integrated system of developmental services, supports, and interventions. Together, we will spark new ideas to ignite the flame of hope with families! **Location: Redbud A/B**

**PRESENTERS**

**Donna Lackie** Project Director, *HMG* MI

HYATT REGENCY LOBBY/FIRST FLOOR

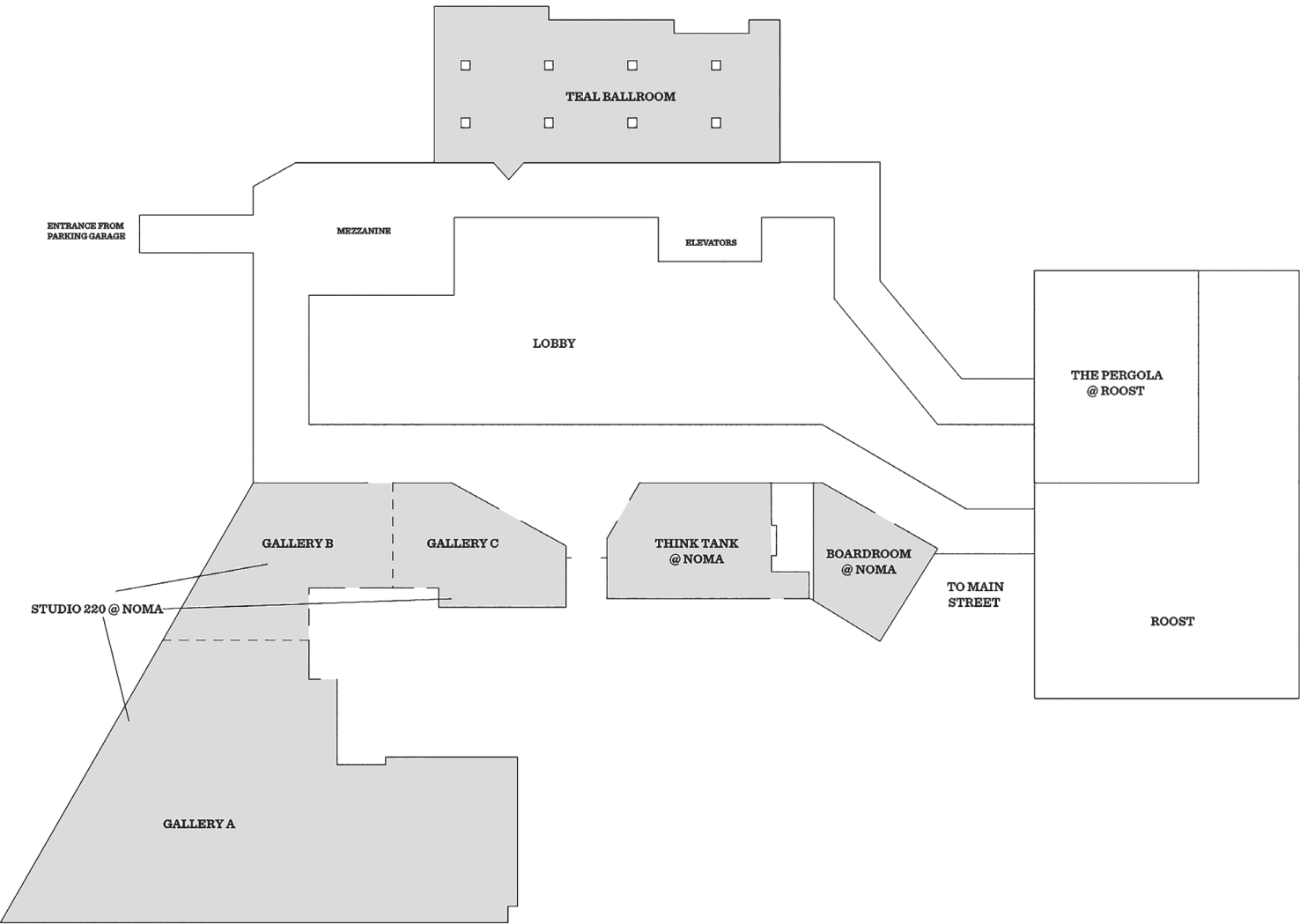

## HYATT REGENCY SECOND FLOOR

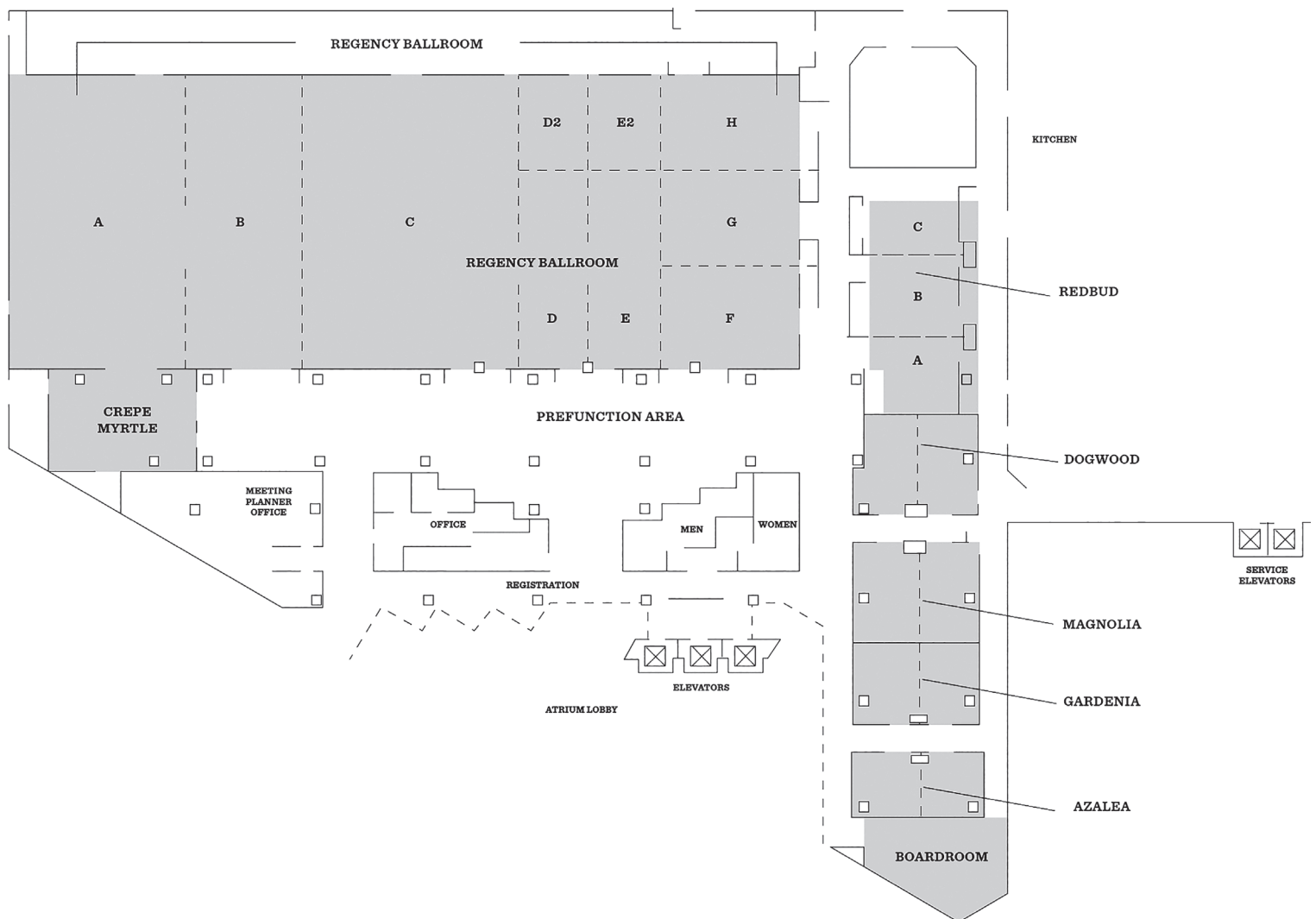

# NOTES



“I want a society where we support families. And where families know that they are doing the most important work in this country.”

Barb Leavitt, Program Manager  
HMG UT #HMGForum2015

## ***HELP ME GROW*** FORUM PLANNING COMMITTEE

*Enormous thanks to the Committee for their eight months of dedicated, tireless effort to make this 2016 Forum the best it could possibly be.*

Katie Naman (AL)  
Cindy Reed (CA)  
Paulina Gyan (DE)  
Katherine Suarez Espinosa (FL)  
Liliana Gomez (FL)  
Rebecca Goldsmith (IA)  
Donna Lackie (MI)  
Kelly Monson (MN)  
Catherine Miller (MO)  
Ericka Dickerson (NJ)  
Amanda Kellenberg (NY)  
Kali Iverson (UT)  
Janet Kilburn (VT)  
Stephanie Orrico (WA)

### **South Carolina Forum Planning Committee Members**

Jane Witowski  
Jamie Moon  
Rosemary Wilson  
Desmond Kelly  
Lisa Soenen  
Jill Kelly  
Linda Brees  
Eric Bellamy

## ***HELP ME GROW*** NATIONAL CENTER

**Paul Dworkin** Founding Director  
**Kimberly Martini-Carvell** Executive Director  
**Joanna Bogin** Senior Consultant  
**Sara Sibley** Manager  
**Erin Cornell** Program Manager for Research, Innovation & Evaluation  
**Von Jessee** Program Specialist for Research and Evaluation  
**Sarah Zucker** Program Specialist for Innovation, Collaboration & Production  
**Lindsay Haythorn** Administrative Assistant

*Thank you to the Office of Community Child Health team at Connecticut Children's Medical Center in Hartford, Connecticut.*

*Graphic design by Becky Karush | [beckykarush.com](http://beckykarush.com)*





# HELP ME GROW NATIONAL FORUM 2016 SPONSORS



INSTITUTE *for* CHILD SUCCESS



*Advancing* **Developmental Promotion,  
Early Detection & Linkage to Services**

282 Washington Street Hartford, CT 06106

860-837-6232 | [info@helpmegrownational.org](mailto:info@helpmegrownational.org) | [www.HelpMeGrowNational.org](http://www.HelpMeGrowNational.org)