

NEW ON THE MARKET

AUVI-Q EPINEPHRINE AUTOINJECTOR



Auvi-Q (an abbreviation for Audio Visual Que) is a new type epinephrine autoinjector manufactured by Sanofi that has received FDA approval and is on the market. Instead of a cylindrical tube, the medication and needle is in a small plastic container the area of a credit card and the thickness of a cell phone - 3 3/8" high, 2" wide and 5/8" thick. There are 0.3 mg adult and 0.15 mg pediatric dose versions. Unique to the product is that opening the package triggers voice prompts on locating where to inject, countdown on dispensing the medication and on completion a beep and flashing light to tell the patient the medication has been administered and the needle is automatically retracted. A trainer model is available. There is also an

Auvi-Q Companion App that can be downloaded and turn a smartphone into an Auvi-Q trainer simulator. It also has a shareable allergy profile and an emergency text to preset contacts. Retail pricing for a package containing two injector units and a trainer is competitive in the \$240 to \$250 range with EpiPens. There are manufacturer \$60 and \$100 off coupons available to patients to help offset insurance co-pays.

INSTRUCTIONS FOR USE

How to use Auvi-Q™

1. Pull Auvi-Q™ from the outer case
2. Pull off Red safety guard
To avoid an accidental injection, never touch the black base of the auto-injector. If an accidental injection does occur, seek medical help immediately. NOTE: The safety guard is meant to be tight. *Pull firmly to remove.*
3. Place black end against the middle of the outer thigh (through clothing, if necessary), then press firmly and hold in place for 5 seconds. Each device is a single-use injection. Note: Auvi-Q™ makes a distinct sound (click and hiss) when activated. This is normal and indicates Auvi-Q™ is working correctly.

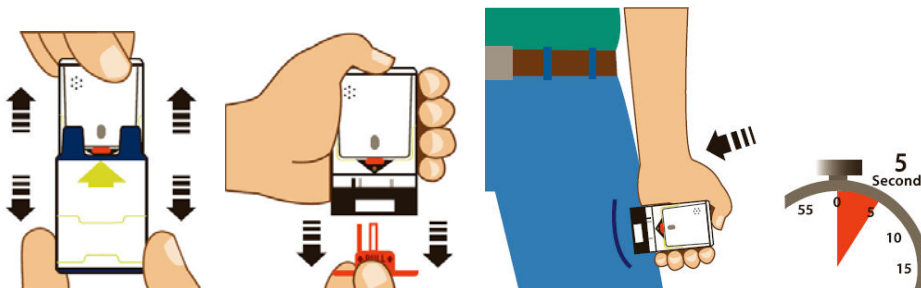

For more information go to www.auvi-q.com

MEDIDOCK ANTI-IDLE POWER SYSTEM is a free standing docking system to provide stationary power for onboard batteries and medical equipment plus internal power and heating/cooling to meet the special requirements of on-call emergency vehicles. The outdoor kiosk, constructed of rugged stainless steel requiring little to no maintenance, has been tested in demanding weather down to -40 degrees F. On-board medical equipment these days can include suction machines, EKG monitors, ventilators, IV warmers, refrigerators, lanterns, etc. The MediDock kiosk includes:

- Retractable 20 Amp electrical extension cord
- 14,000 BTU air conditioning
- 22,000 BTU heat
- 20 Amp GFCI outlet for operators convenience

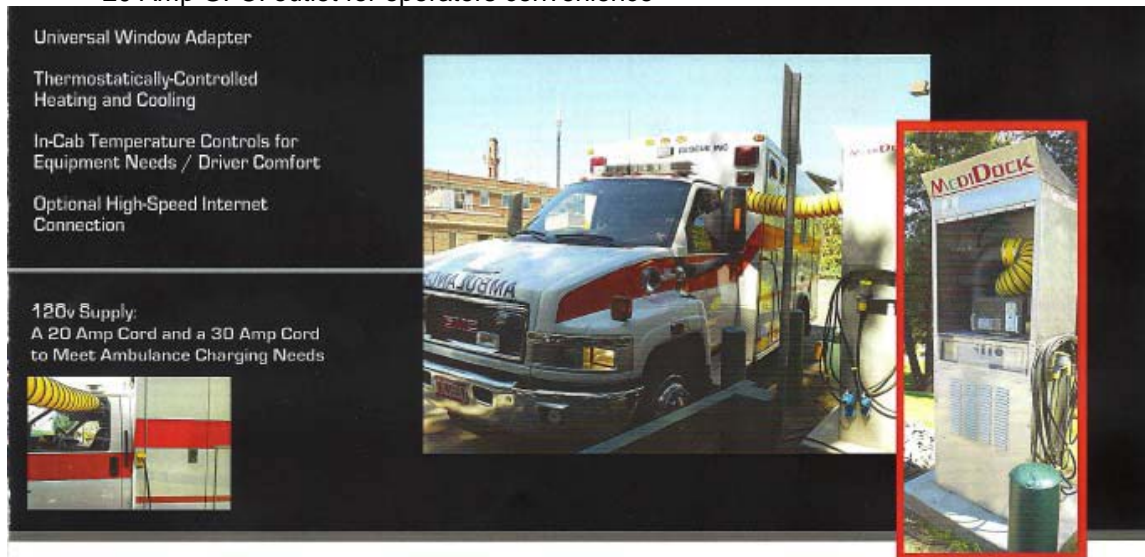

The kiosks cost about \$14,000 each. The US Environmental Protection Agency provided a federal grant to Vermont which in turn covered the cost of two units plus installation at Brattleboro (VT) Memorial Hospital to serve as a trial facility for the technology. Hospitals have an interest in minimizing diesel fuel exhaust from ambulances which may be idling outside their emergency department doors for 20 minutes or longer. For additional information contact Frank Podgwaite, Airedock/Medidock, North Haven, CT 06473, 203-887-0209 cell, f.podgwaite@twmgct.com, www.airedock.com