

3rd Annual  
**SUSQUEHANNA TRAIL  
DISTRICT**

**PINEWOOD DERBY**



**April 9th 2016**



**At St. Matthew's Luthern Church  
839 W. Market St York Pa 17401**



Susquehanna Trail District Pinewood Derby

Saturday April 9, 2016

Held at: St. Matthew's Lutheran Church

839 West Market Street, York, PA 17401



Registration and Inspection Times: 9:30am to 11:00am Races will start promptly at 11:30am!

This Derby is open to any Susquehanna Trail District Cub Scouts whether they placed at the pack level or not.

This District Derby will hold Races in:

Tiger, Wolf, Bear, Webelo I & II Den Races and the District Champion Race!

Other races and activities will include:

Demolition Race, Out Law Race, a Car Show, Food and more!

Each registered participant will receive a participation Metal!

All placed winners will receive a trophy!

All District Pinewood Derby Registration, Roster and Money are due by March 25, 2016.

Make all checks payable to: NBOFC and mail to the York Service Center

2139 White St York, PA 17404 ATTN: Brandyn Holtzinger

If you have any question, please contact Frank LittleBear SQT District Cub Activities Chair at:  
cubscoutactivities@gmail.com / 717-858-6911

## **IT'S DERBY TIME!**

Cub Scouts just like you have been building their own cars and competing in Pinewood Derby events since 1953! At the heart of this event's success is the process itself - bonds are strengthened as the Cub Scout partners with a parent or adult mentor to design, carve, paint, weigh, refine, and race the car. In addition, Cub Scouts build confidence and take pride in their own growing skills and hard work. So enjoy the ride! We want Scouts and their families to enjoy a wholesome, constructive activity that will foster a closer family relationship and promote craftsmanship and good sportsmanship through this event!

## **Den and District Champion Race Info: Registration Fee is \$5.00**

These races are open to all Cub Scouts in Tiger, Wolf, Bear or Webelo I & II Dens whether you did or did not place at the pack level.

To enter you must be a registered NBOF Cub Scout with-in the Susquehanna Trail District. All Cub Scouts must have their car inspected and registered between 9:30 am and 11am but no later than 11:00am to qualify for their race. All entries must comply and will be held accountable by the general rules of this packet. All race brackets will be ruled by an elimination process. Each Den will have a 1st, 2nd and 3rd place 2016 winner. All winners from those races will advance to the District Champion Race and earn the title 1<sup>st</sup>, 2nd or 3rd place 2016 Susquehanna Trail District Champion! Only one derby car per-entry!

## **Outlaw Race Info: Registration Fee is \$3.00**

The Outlaw Derby is open to any cub scout's **siblings (Brothers or Sisters)**.

The Outlaw Derby is a Pinewood Derby with rules that are either identical or more lenient than the standard Derby rules. This race gives other family members (**Brothers or Sisters**) the opportunity to build a car and enjoy the Pinewood Derby experience.

To enter, you need to be related to a Cub Scout, registered with the NBOF and serving in Susquehanna Trail District. All siblings must have their car inspected and registered between 9:30 am and 11:00am but no later than 11:00am to qualify for their race. All entries must comply and will be held accountable by the general rules of this packet.

## **Demolition Pinewood Derby Info: Registration Fee is \$3.00**

You'll notice that after the Derby has ended and parents are "cleaning-up" from the event. One innocent cub slides his car across the open floor, followed by another, and yet another. Within a few minutes, several cars are skittering quickly across the floor at the same time and then. . . BANG! It happens! A single collision takes place. There are a couple seconds of silence as the "racers" process what just happened. Then, as if all the boys simultaneously read each other's minds, an event of massive carnage unfolds in the blink of an eye! Cars everywhere collide with walls, chairs, and each other!

Thus was the beginning of the Demolition Pinewood Derby. This event is now much more refined from the primal carnage described above, but the high impact action and crashing satisfaction is still there.

Imagine a U-shaped track, 32 feet in length, no center guiderails, and barely enough width for two cars to pass side by side. A single car is placed at either end of the track. They are released simultaneously. The cars barrel down the track, speeding directly at each other, destined for a head on collision! The results? A spectacular crash at the center of the track, with usually one car being thrown from the track (the loser) and the other car remaining on the track (the winner). Scores are tallied and eliminations are processed, then the next pair of cars repeat the process.

This bracket is open to all Cub Scouts and their siblings. An additional car is required; you must be a registered NBOF Cub Scout with-in the Susquehanna Trail District. All brackets will be ruled by an elimination process until a 1st, 2nd and 3rd place 2016 winner emerges!

### **Demolition Basic Rules are:**

- One Car per-entry-registration and inspection rules apply
- If one car is disabled (no longer in a “race worthy” rolling condition) and unable to run again, it loses that heat and is eliminated from further competition.
- If both cars in a given heat are disabled, both are eliminated from further competition.
- If both cars survive a heat in “race worthy” rolling condition, the car that comes to rest with at least one wheel in contact with the track (not counting wheels that are separated from the car), shall be declared the winner.
- If both cars survive a heat in “race worthy” rolling condition, and BOTH cars come to rest with at least one wheel in contact with the track, the car that came to rest closest to the marked mid-point of the track shall be declared the winner of that heat.
- If both cars survive a heat in “race worthy” rolling condition, and BOTH cars are knocked completely off the track (neither car comes to rest with a wheel in contact with the track), the car that measures closest to the mid-point of the track will advance.

### **General Rules and Check-In Procedure:**

1. GOOD SPORTSMANSHIP AND BEHAVIOR IS EXPECTED. Race Officials may ask anyone not following this rule to leave.
2. To enter the Den, District Championship and Demolition races: You must be a registered NBOF Cub Scout with-in the Susquehanna Trail District. You may enter more than one car but they cannot race in the same division.
3. Each car entered must be made born an Official BSA Pinewood Derby Kits.
4. All Race brackets will be ruled by an elimination process. Each Den will have a 1st, 2nd and 3rd place winner. All winners from those races will advance to the District Champions Race.
5. The Outlaw Race is for any sibling (Brother, Sister) of a registered NBOF Cub Scout with-in the Susquehanna Trail District.
6. If a car jumps off the track or interferes with another car the heat run again. If it happens again, the car loses the heat. (Excluding the Demolition Race)
7. All Scouts must be present when having their car inspected and registered between 9:30 am and 11:00am but no later than 11:00am to qualify for their desired race(s). This includes the Demolition and Outlaw race.
8. Only **ONE** official race scale will be used to weigh in all cars at check-in. Once your car passed Inspection, it will then be impounded until race time. Only appointed officials will be allowed to handle the Derby Cars until race concludes.
9. The car should be substantially built by the Cub Scout. Parental supervision and guidance in the construction of the car is encouraged, but the parent **SHOULD NOT BUILD THE CAR FOR THE CUB SCOUT.**
10. If a car breaks down during a race, Race Officials will allow you 5 minutes to take your car to the Pit Crew area for repairs. Then Officials will run the heat again. If the car cannot be fixed in 5minutes, you lose the heat. If you're unable to make any repairs to the car it may result in disqualification. **THIS RULE DOES NOT APPLIY TO THE DEMOLITION RACE.**
11. Other areas of judging and special recognition for Den level entries will go for craftsmanship and creativity during the Scout Car Show. We encourage each scout to “Do Your Best”!
12. The District PWD Director, Officials and Track Steward may disqualify any car that in their determination is not in compliance with the spirit of the District Pinewood Derby Race.

**NO REFUND TO ANY SCOUT(S) OR SIBLING WHO'S DISQUALIFIED OR CAR DOES NOT PASS INSPECTION!**

**All Pinewood Derby Car entries for District Den, Champions, Demolition and Outlaw brackets MUST meet the following requirements to pass inspection for registration.**

**Car Dimension Rules:**

- The overall length of the car shall not exceed 7 inches.
- The overall width of the car shall not exceed 2- 3/4inches.
- The car must have 1-3/4inches between the wheels.
- The car must have 3/8" clearance underneath the body so it does not rub on the track. **This includes any weights place underneath car.**
- The maximum height of the car is 3- 1/2inches including accessories.
- Wheelbase must be **Standard from Kit!**

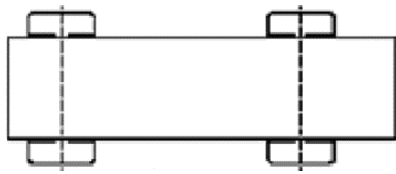

**Standard Wheelbase only**

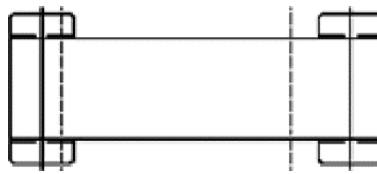

**NO Extended Wheelbase**

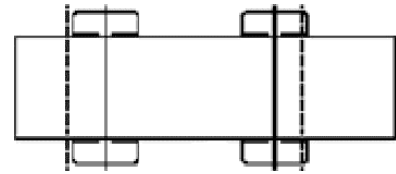

**NO Shorten Wheelbase**

**Derby Car Weight Rules:**

- The car must not exceed 5.0 ounces or 141.grams
- Scouts will be given the opportunity to make adjustments needed so their car's weight meets qualification.
- Any car that weighs more the 5.0 ounces and cannot be adjusted will be disqualified.
- **Note: Only Demolition Cars can weigh over 5.0oz but no more than 10.0oz for this special event.**

**Wheels and Axles**

- The wheels must be from the Official B.S.A. Pinewood Derby kit or official Pinewood Derby wheel replacement kit. Wheels must be visibly marked. The Car must have all 4 wheels - **NO GUIDE FINES!**
- The original axles (nails) should be used and placed in the original slots/holes provided in the block of wood of the official kit.
- Axles must be firmly attached to the car and may not pivot in the body.
- Axles may be polished.
- NOTE: You may drill axle holes; these holes must line up exactly with the original Standard wheelbase placement.
- **Absolutely NO** Wheel bearings, washers, sticker hubcaps, bushings flexible or spring suspension system of any type and/or motor, rocket, battery, rubber band, magnets or powered propel systems, and no Guide fins in place of wheels and/or axles.
- **No bent or angled axles into the car body. Axles must be placed straight.**

**Lubrication:**

- Only dry lubricant including graphite powder, Teflon powder, or others, may be used to lubricate wheels.
- **Absolutely NO** oil or grease lubricants. Non-dry lubricants including those with petroleum, solvent, WD-40, etc. may attack the plastic wheels and keep them from turning freely and can damage or contaminate the track.
- Once the car is impounded after the inspection and weigh-in, wheels may NOT be re-lubricated before or between races.





# Susquehanna Trail District Pinewood Derby Roster

*(Use this form for Pack or Individual Registration)*

Leader/Parent Submitting Registration:

Name: \_\_\_\_\_ Scouting Position: \_\_\_\_\_ Pack: \_\_\_\_\_

Address: \_\_\_\_\_ City: \_\_\_\_\_ State: PA Zip: \_\_\_\_\_

Phone: \_\_\_\_\_ Email: \_\_\_\_\_

Racer	Rank	Official Derby \$5.00	Demolition Derby \$3.00	Outlaw Race \$3.00	Total
1.	T / W / B / WEB I / WEB II / Sibling				
2.	T / W / B / WEB I / WEB II / Sibling				
3.	T / W / B / WEB I / WEB II / Sibling				
4.	T / W / B / WEB I / WEB II / Sibling				
5.	T / W / B / WEB I / WEB II / Sibling				
6.	T / W / B / WEB I / WEB II / Sibling				
7.	T / W / B / WEB I / WEB II / Sibling				
8.	T / W / B / WEB I / WEB II / Sibling				
9.	T / W / B / WEB I / WEB II / Sibling				
10.	T / W / B / WEB I / WEB II / Sibling				
11.	T / W / B / WEB I / WEB II / Sibling				
12.	T / W / B / WEB I / WEB II / Sibling				
13.	T / W / B / WEB I / WEB II / Sibling				
14.	T / W / B / WEB I / WEB II / Sibling				
15.	T / W / B / WEB I / WEB II / Sibling				
16.	T / W / B / WEB I / WEB II / Sibling				
17.	T / W / B / WEB I / WEB II / Sibling				
18.	T / W / B / WEB I / WEB II / Sibling				
19.	T / W / B / WEB I / WEB II / Sibling				
20.	T / W / B / WEB I / WEB II / Sibling				
21.	T / W / B / WEB I / WEB II / Sibling				
22.	T / W / B / WEB I / WEB II / Sibling				
23.	T / W / B / WEB I / WEB II / Sibling				
24.	T / W / B / WEB I / WEB II / Sibling				
25.	T / W / B / WEB I / WEB II / Sibling				
<b>Totals</b>					

**All District Pinewood Derby Registration Roster and Money are due by March 25, 2016!!!**

**Make all checks payable to NBOFC and mailed to:**

**York Service Center**

**2139 White St York, PA 17404**

**ATTN: Brandyn Holtzinger**