

Model Car Contest and Swap Meet

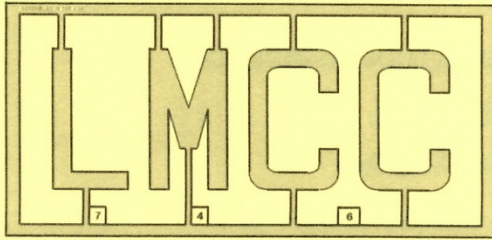

*Lafayette
Miniature
Car Club*

The Lafayette Miniature Car Club Will Once Again Host A Model Car Contest
And Swap Meet

Saturday August 20, 2016

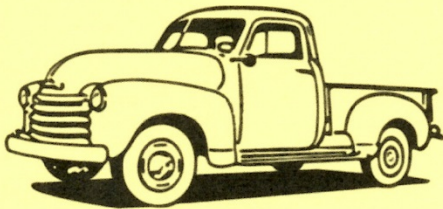

Contest Theme: **"MADE IN INDIANA"**

Award for Judges Top Pick of "Vehicles Made In Indiana"

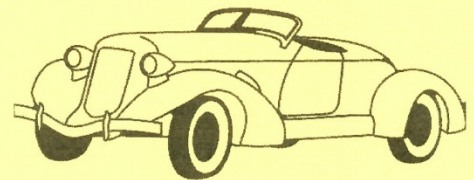
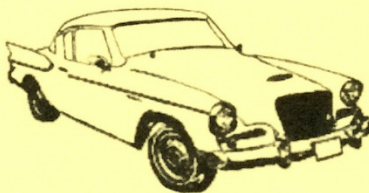
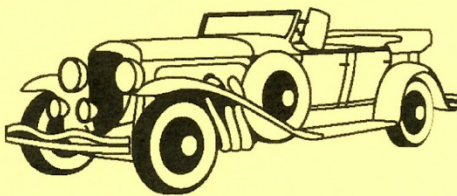

Location: Community Reformed Church
2501 S 18th St, Lafayette, IN 47909

2 Blocks south of Teal Rd. (S.R. 25)
See map on backside

Vendor Set-up:	7:30 am to 9:00 am
General admission:	9:00 am
Registration:	9:00 am to 12:00 noon
Judging:	12:00 noon to 2:00 pm
Awards:	3:00 pm

The C.R.C. Youth Group will have breakfast
and lunch items available for purchase.



Swap Meet / General Admission: \$3.00, 12 and under Free
Contest Entry Fee: Adults \$3 for first model, \$1 each additional entry
Kids 12 and under \$1 up to 3 models, \$1 each additional entry
Vendor Swap Meet Table Fees: \$25.00 8' tables with 2 chairs
Table reservations must be paid for by July 30, 2016

Due to the size of the Church gym and for safety
concerns, the number of vendor tables is limited.

Please reserve your table(s) early!

Contact / Vendor Information:
Bill Erdes - 765-418-4236
scubedu@comcast.net

* Lafayette Miniature Car Club / Community Reformed Church, their members, agents, or officers will not be responsible in case of accidents involving attendees, equipment, merchandise, models, or displays.

Classes

- | | |
|------------------------|--|
| 1. BARE BONES - | NOTHING BUT GLUE FOR ASSEMBLY, MUST INCLUDE INSTRUCTIONS |
| 2. OUT OF THE BOX - | PAINT, BMF ALLOWED - <u>MUST HAVE INSTRUCTIONS</u> |
| 3. STOCK - | DOCUMENTATION REQUIRED (Pictures, Sales Ads, Etc.) |
| 8. STREET ROD - | 48 AND EARLIER - STREET LEGAL - LIGHTS - LICENSE PLATES - ETC. |
| 9. STREET MACHINES - | 49 AND NEWER - STREET LEGAL - LIGHTS - LICENSE PLATES - ETC. |
| 10. COMPETITION - | STRAIGHT LINE -- OPEN WHEEL -- CLOSED WHEEL |
| 11. SERVICE VEHICLES - | POLICE -- FIRE -- RESCUE -- TOW TRUCKS -- MILITARY -- ETC. |
| 12. MOTORCYCLES | |

- | | |
|--|------------|
| 4. CUSTOM- | |
| 5. CURBSIDE | |
| 6. LOWRIDERS | |
| 7. RAT RODS | |
| 17. JUNIOR - | 13 THRU 16 |
| 18. NOVICE - | THRU 12 |
| BEST OF - | |
| GM -- FORD -- MOPAR -- OTHER MAKES | |
| PAINT -- INTERIOR -- ENGINE -- JUNIOR/NOVICE | |
| SHOW -- MADE IN INDIANA | |
| MIKE VEACH MEMORIAL AWARD | |

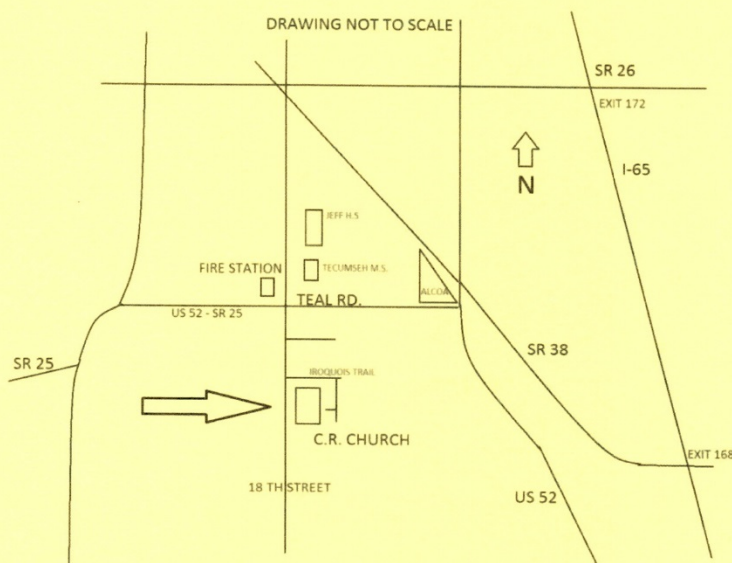

GENERAL RULES

JUDGES DECISIONS ARE FINAL.

CONTEST DIRECTORS RESERVE THE RIGHT TO MOVE ANY ENTRY TO A "PROPER" CLASS.

CLASS ENTRIES REQUIRING INSTRUCTIONS, DOCUMENTATION, LIGHTS, ETC., WILL NOT BE JUDGED IF INCOMPLETE.

MUST BE 3 ENTRIES TO COMPLETE A CLASS --

CLASSES MAY BE COMBINED, ADDED, OR DROPPED DEPENDING ON NUMBER OF ENTRIES.

NO SWEEPS (No 1, 2, 3, Awards unless the entrant is the only entrant in the class).

NO LARGE DISPLAY BASES (No more than 1" in any direction past vehicle).

JUDGING BEGINS AT NOON -- TURNTABLES MUST BE TURNED OFF BEFORE JUDGING STARTS.

ONCE JUDGING STARTS, ALL CONTESTANTS MUST STAY AWAY FROM CONTEST AREA.

PLEASE RESPECT OTHER PEOPLES PROPERTY -- DO NOT MOVE OTHER ENTRANTS MODELS --
IF MORE ROOM IS NEEDED, CONTACT A CONTEST OFFICIAL FOR ASSISTANCE